

Annex C

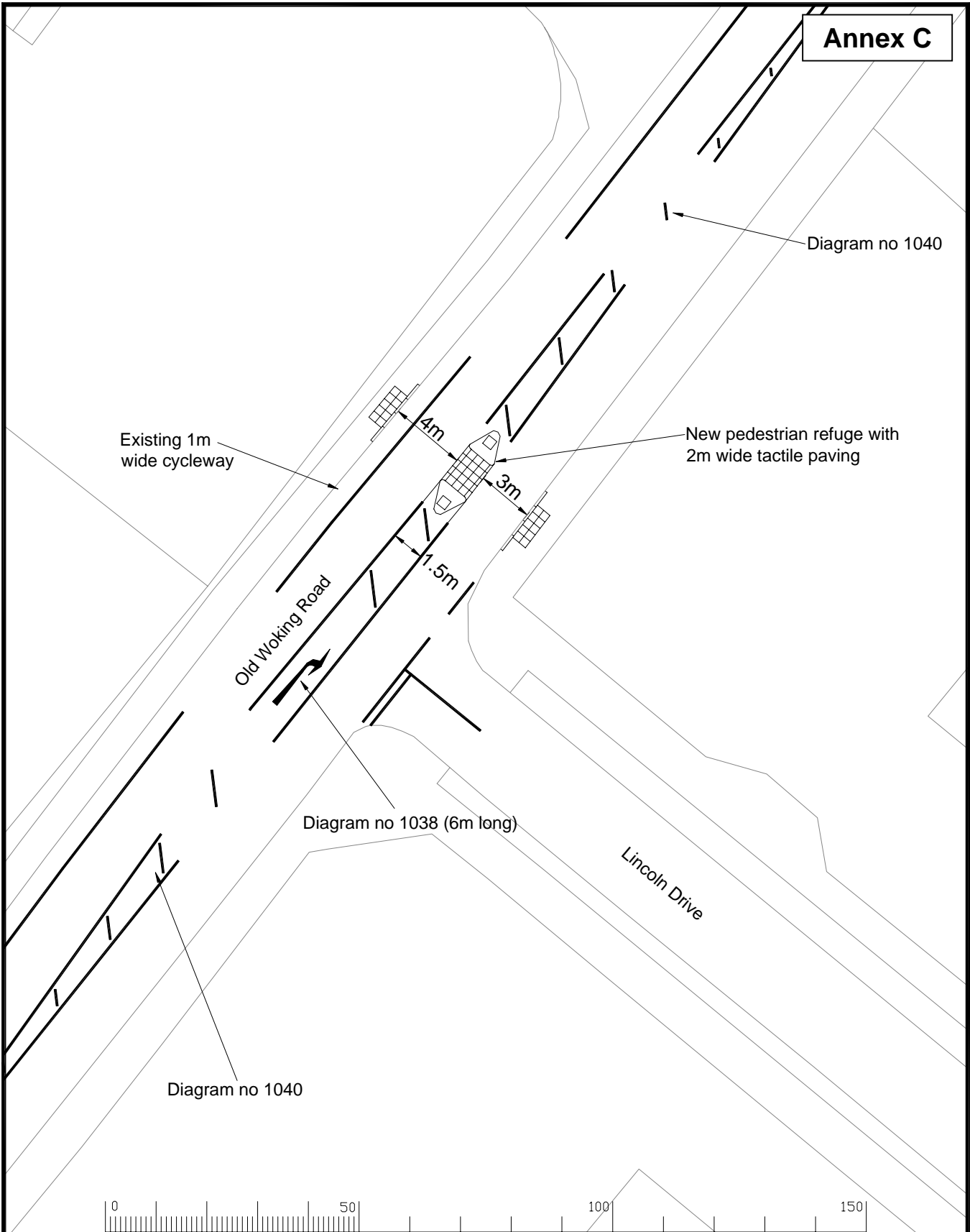

"Based upon the Ordnance Survey mapping with permission of the Controller of Her Majesty's Stationery Office © Crown copyright. Unauthorised reproduction infringes Crown copyright and may lead to prosecution or civil proceedings." Surrey County Council LA 076872 1996.

Drawn by	Sig.	Date
DO		11.7.05
Checked by	Sig.	Date
originator		
Approved by	Sig.	Date

PROJECT
OLD WOKING ROAD

DRAWING
**PROPOSED PEDESTRIAN REFUGE
OPTION 2**

SURREY COUNTY COUNCIL
Environment
Head of Engineering: C.M.Findley, B.Sc., M.Sc., C.Eng., F.I.C.E.

Project No.
Contract Sheet No.
Drawing No. 12018
Revision -
Classification